

THOMAS H
WOOD

215, Wynclyffe Gardens,
Pentwyn,
Cardiff,
CF23 7FD

1 Bed Apartment

£795 PCM

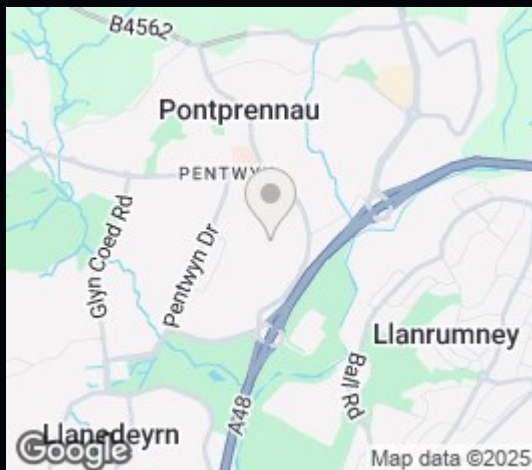

A super one bedroom modern apartment on the first floor of this well maintained development in Pentwyn/Pontprennau. This immaculate property has been exceptionally well appointed and decorated and is conveniently located for Waitrose/Lidl supermarkets, major road networks M4 and A48 as well as UHW. UNFURNISHED with kitchen appliances. Off road parking bay. Electric heating. EPC Rating B. Council Tax band C. Available May 2025 for initial minimum term of twelve months.



1



1



1



B

£795 PCM

CONTACT

EMAIL

lettings@thomashwood.com

TELEPHONE

02920 626252

WEBSITE

Energy Efficiency Rating		
	Current	Potential
Very energy efficient - lower running costs		
(92 plus) A		
(81-91) B	83	87
(69-80) C		
(55-68) D		
(39-54) E		
(21-38) F		
(1-20) G		
Not energy efficient - higher running costs		
England & Wales	EU Directive 2002/91/EC	

Ground Floor

Approx. 503.4 sq. feet

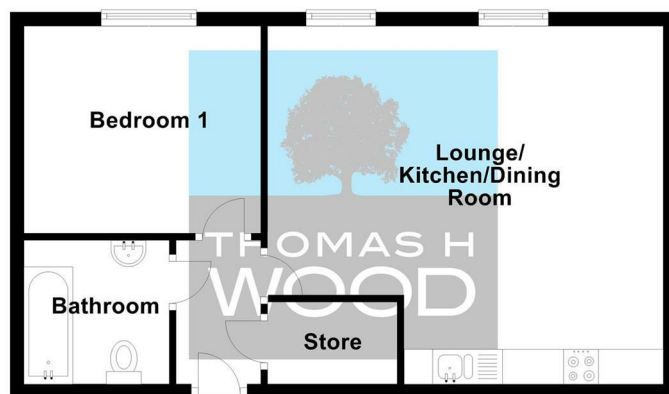

Total area: approx. 503.4 sq. feet